

**NOTES:**

- Traffic sign
  - Cone
  - Work Area
  - Safety Zone
  - Diversion
  - WORKS ACCESS
  - WORKS EXIT
- Works access/egress to be risk assessed on site for suitability of location

**TRAFFIC MANAGEMENT NOTES**

**ROAD CLOSURE :**

- NOTES**
- All traffic signs shall comply with Chapter 8 of the Traffic Signs Manual
  - All traffic management equipment shall be provided by the Contractor, unless otherwise specified.
  - All signs shall be positioned so as not to be obscured by any other objects and shall not obstruct any other sign, permanent or temporary as much as is reasonably practicable.
  - All traffic signs shall meet the reflectorisation requirements of BS 873 : Part 6 : 1983, Table 1.
  - Works Access/Egress to be positioned to suit ongoing works.



**SPEED OF ROAD:**

LONGWAYS: 0.5m  
SIDEWAYS: 0.5m

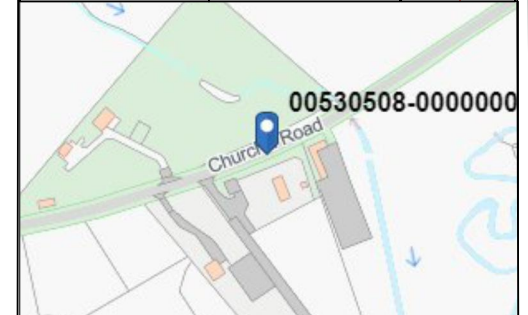

A	A
B	B
C	C
D	D

- NOTES:**
- All signs and cones to be in accordance with Chapter 8 new roads and street works a code of practice (Red book)
  - Works access and egress are indicative, exact locations to be agreed on site.
  - Safety zones are to be installed as required as shown by the SAFETY ZONE DIMENSIONS BELOW
  - All signs to be located so as not to obscure signs or objects and should be ballasted near to ground level using sand filled hessian bags or sign straps.
  - All sign positions are indicative only and must be accurately positioned on site with good visibility and be clear of and obstructions or vegetation at all times.
  - Drawing not to scale

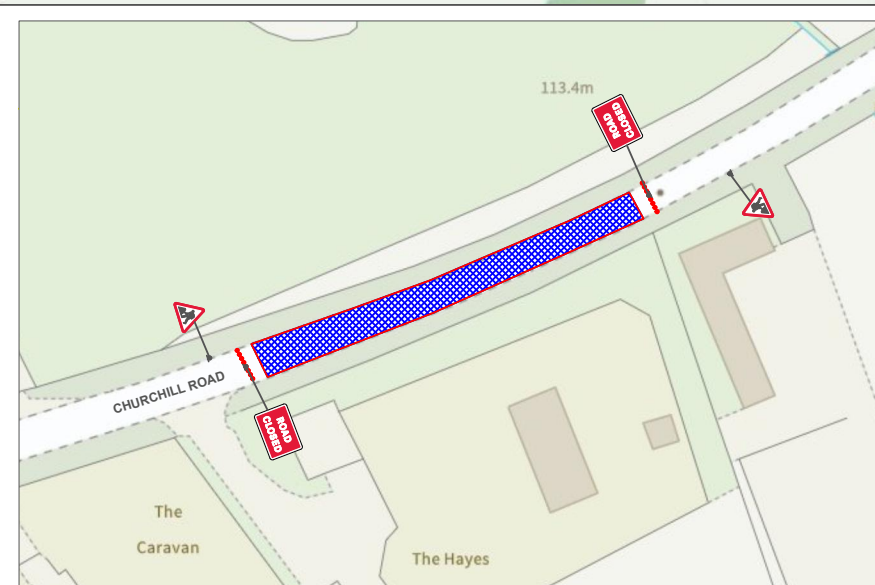

**DIVERSION ROUTE:**  
CHURCH STREET  
STATION ROAD  
B4450

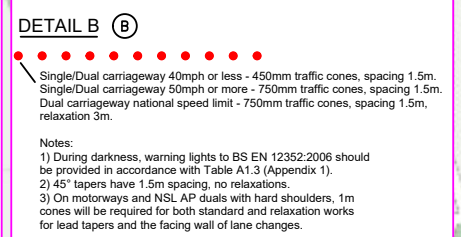
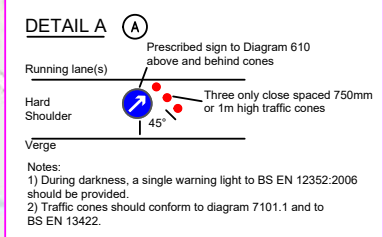

**CLIENT:**

**SITE:**  
THE HAYES, CHURCHILL ROAD, KINGHAM, OX7 6TA

**GRID REF:** -----

**TITLE:** ROAD CLOSURE

SCALE AT 13: NTS	DATE:	DRAWN: JORDAN.C	CHECKED: JACK . B
DWG NO: TMSW4228	REV NO:	001	